

MXN94C

Owner's Manual

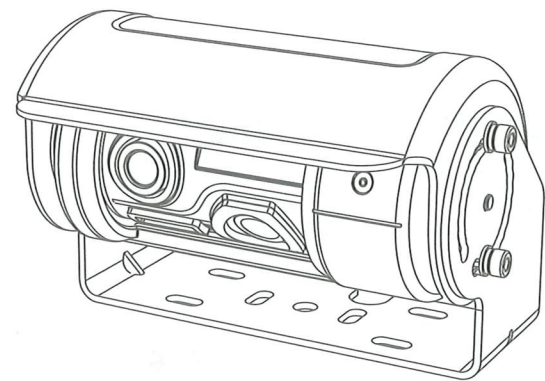

- 1 FEATURES
- 2 ANGLE OF VIEW
- 3 HOW TO REPLACE WIPER RUBBER
- 4 COMPOSITION
- 5 INSTALLATION
- 6 SPECIFICATIONS

1 FEATURES

- Motorized Shutter Twin View Camera
- 1/3" Super HAD II CCD
- Automatic electronic iris
- Ultra low light performance
- Extra-wide field of view
- Input voltage DC 12V from monitor
- Automatic cleaning function
- Automatic shutter / heating function
- Normal / Mirror image switching
- Vandal resistance
- Water-proof (I.P68)

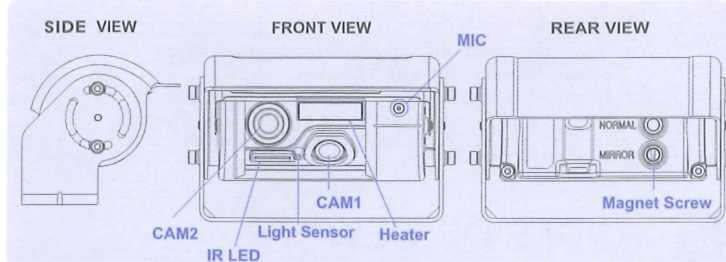

Magnet Screw

- User can easily change mirror/normal image by changing magnet screw position.
- How to change: Unscrew magnet from the camera and screw the magnet into mirror or normal hole using a driver.

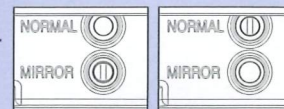

Camera connector pin description.

Pin No.	Description	Pin No.	Description
1	Shutter/Heating	1	Shutter/Heating
2	Audio	2	Audio
3	Video 1	3	Video 1,2
4	Ground	4	Power
5	Video 2	5	Ground
6	Power		

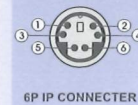

2 ANGLE OF VIEW

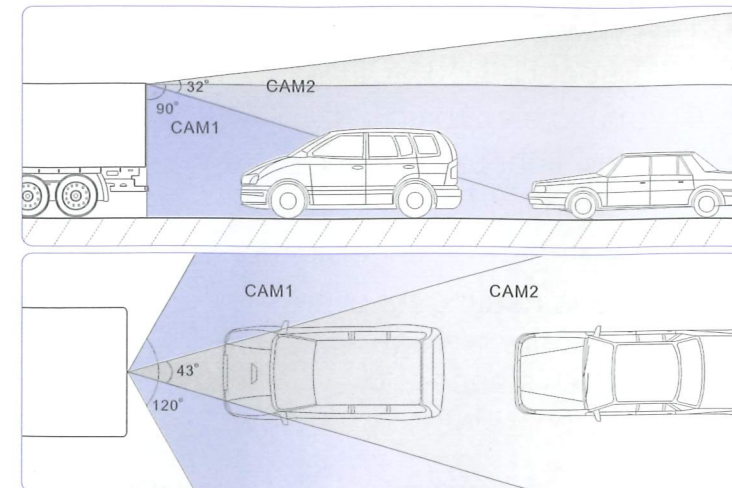

3 HOW TO REPLACE WIPER RUBBER

- Remove the wiper rubber as above picture shown.
- Put on supplied wiper rubber on the wiper hole.
- Fix the rubber into the hole by pushing with your finger.

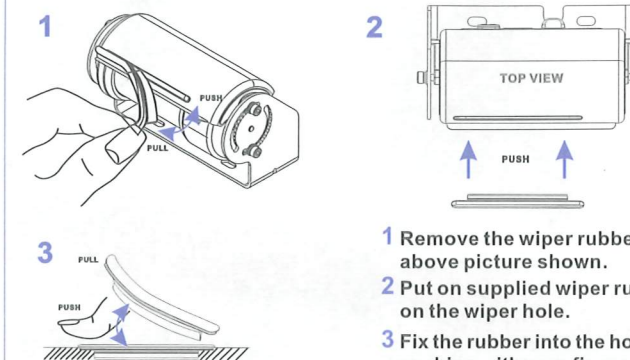

4 COMPOSITION

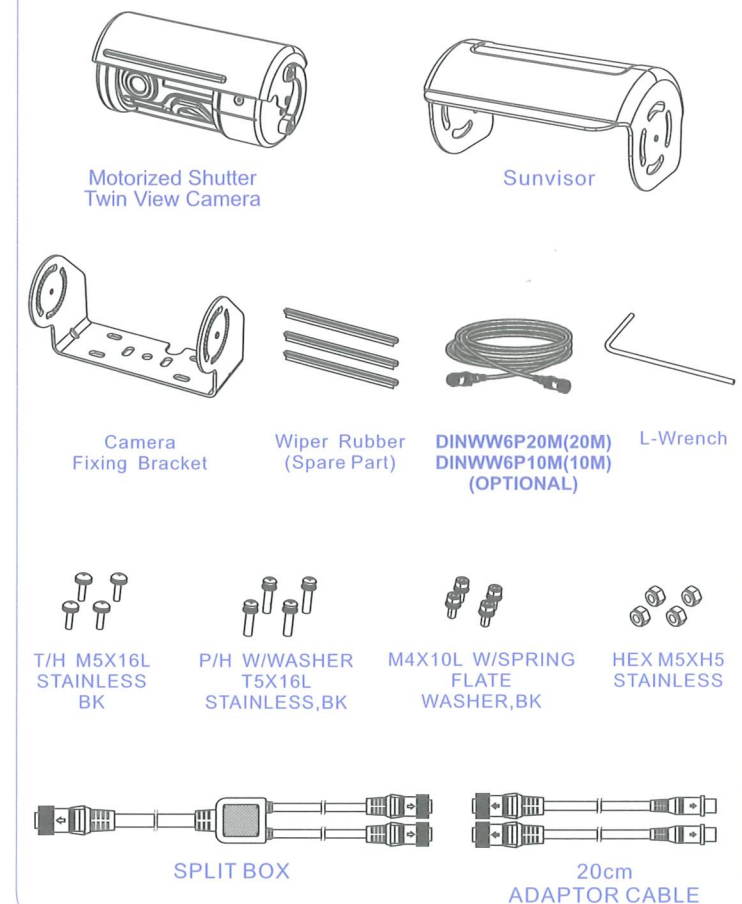

5 INSTALLATION

- A. Fix the supplied mounting bracket to the vehicle.
Adjust the angle of the camera and fasten the screws firmly.

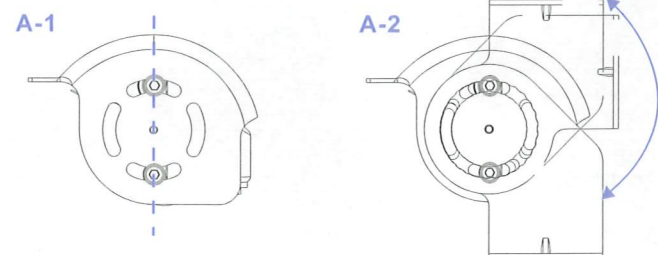

- A-1. Recommended guide line for assembling sunvisor.
A-2. User can adjust the installation angle.

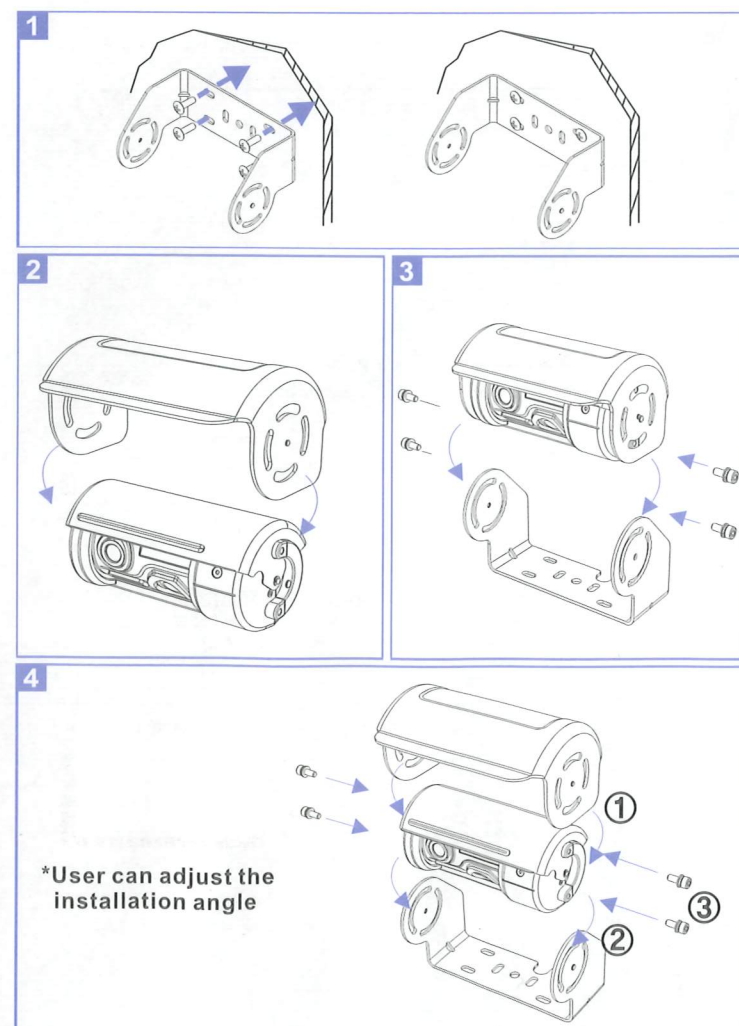
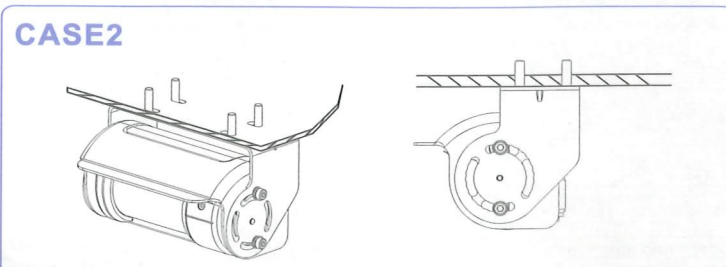
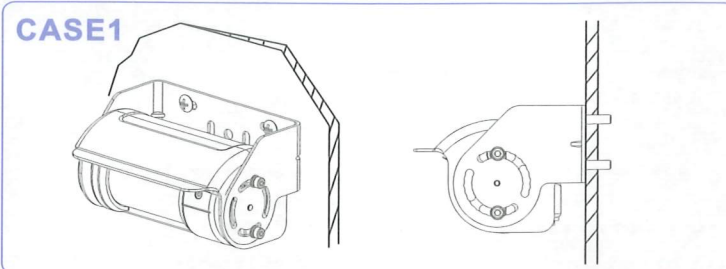

*User can adjust the installation angle

- B. Run the cable from the monitor to the camera

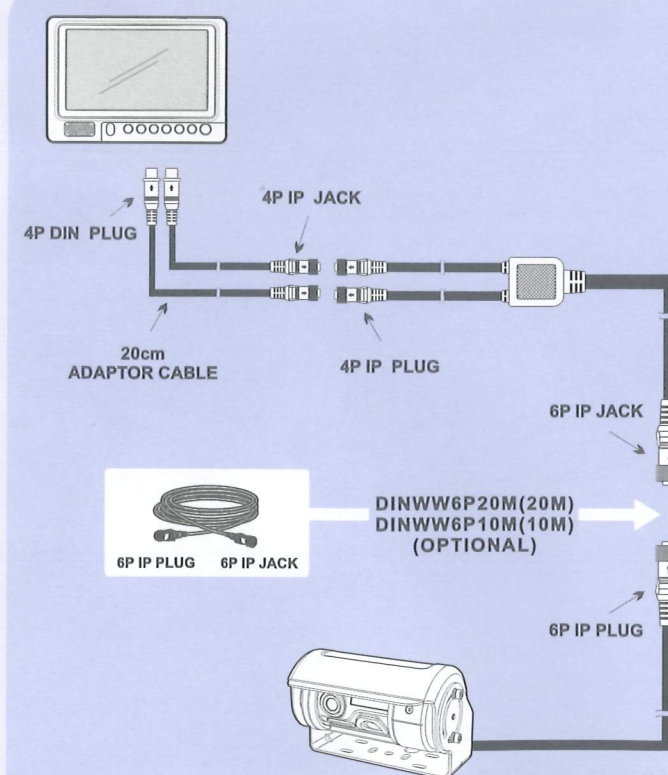

NOTE! USE ACID FREE VASELINE/GREASE IN BETWEEN THESE CONNECTORS BEFORE FIXATION FOR A GUARANTEED LONG LIFETIME

6 SPECIFICATIONS

Image
Picture elements
Image size
Lens

Synchronization
Horizontal resolution
Required illumination

Signal to noise ratio
Power supply
Power consumption
Vibration
Impact
I.P Factor
Operating temp.
Case Material

Weight
Dimensions

Supplied accesories

- Interline transfer type CCD
- NTSC : 270,000 pixels PAL : 320,000 pixels
- 1/3 Inch
- CAM1 : Diagonal : 150°
Horizontal : 120°
Vertical : 90°
- CAM2 : Diagonal : 53°
Horizontal : 43°
Vertical : 32°
- (Optional Different Lens Available.)
- Internal
- More than 330TV lines
- CAM1 : 0Lux.(IR LED ON) W/ 4 IR LED
- CAM2 : 1Lux.
- Better than 50dB (at AGC off)
- 12V DC
- MAX 5.0W(at IR LED and Heater on)
- 6G
- 100G
- I.P 68 (W/Mic.), I.P 69K (W/O Mic.)
- 10 C ~50 C (-14 F~ 122 F)
- Window : Curved Glass
- Body : Aluminum
- Approx. 650g
- 114(W) x 57(H) x 59(D)mm
(4.5(W) x 2.2(H) x 2.3(D) inch)
- * Camera Fixing Bracket (1)
- * Instruction Manual (1)
- * Screw Kits (1)
- * Sunvisor (1)
- * Wiper Rubber(Spare Part) (3)
- * Spit box (1)
- * Adaptor Cable (2)