

MXN22C Camera



Features

- Best picture quality (in combination with Digital LCD monitor)
- High resolution CMOS camera (1.23Mega pixels)
- 1/3.2" Color CMOS high resolution image sensor
- IP69K Waterproof Rating
- Built-in IR LED's
- Diagonal 130° viewing
- Normal/Mirror Image adjustable
- Built-in Microphone (for one-way audio)
- Multi purpose (Frontview, sideview, rearview, surveillance, etc)
- Built-in Automatic Heater (below +10°C)
- Anti-corrosive 3-fold coating
- Temp. -40°C ~ 80°C
- Vibration resistant
- CE and EMC approved

Optional versions of model MXN22C:

MXN22C-078 78°(D) x 62.0°(H) x 45.0°(V)

MXN22C-040 40°(D) x 30.9°(H) x 23.2°(V)

MXN22C-020 20°(D) x 17.0°(H) x 12.8°(V)

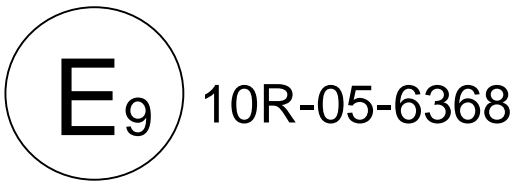

Contents

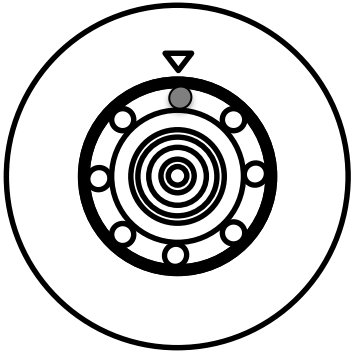

Camera x 1

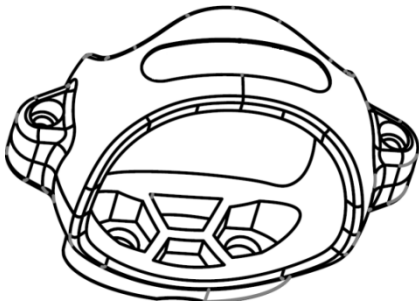

Camera Bracket x 1

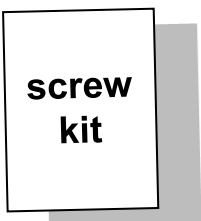

Screw kit x 1

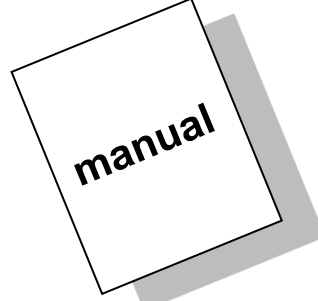

Manual x 1

Technical Specifications

Image Sensor	: 1/3.2" Color SONY CMOS(Exmor)
Picture elements	: PAL, 1.23Mega pixels(1280x960)
Resolution	: 750TV lines
S/N ratio	: Minimum 45dB (at AGC off)
Minimum illumination	: 0 Lux (IR LED's on)
Power range	: DC 9 ~ 48V
Power consumption	: DC 12V, 265mA (heater on) DC 12V, 165mA (heater off)
Operating temperature	: -40°C to +80°C
Viewing angle	: 130°(D) x 102°(H) x 76°(V)
Dimension	: Ø52mm, 72(W) x 51(D) x 63(H) incl. bracket
Weight	: Approx. 215g
Supplied Accessories	: Camera Bracket (1) Stainless M6 x 25mm bolt + M6 nut (2 + 2) Stainless M3 x 12mm bolt + M3 nut (2 + 2) Stainless M4 x 16mm tapping screw (2) Rubber washer + stainless metal washer (2 + 2) Rubber O-Ring (2) Allen wrench 3mm (1)

Front View

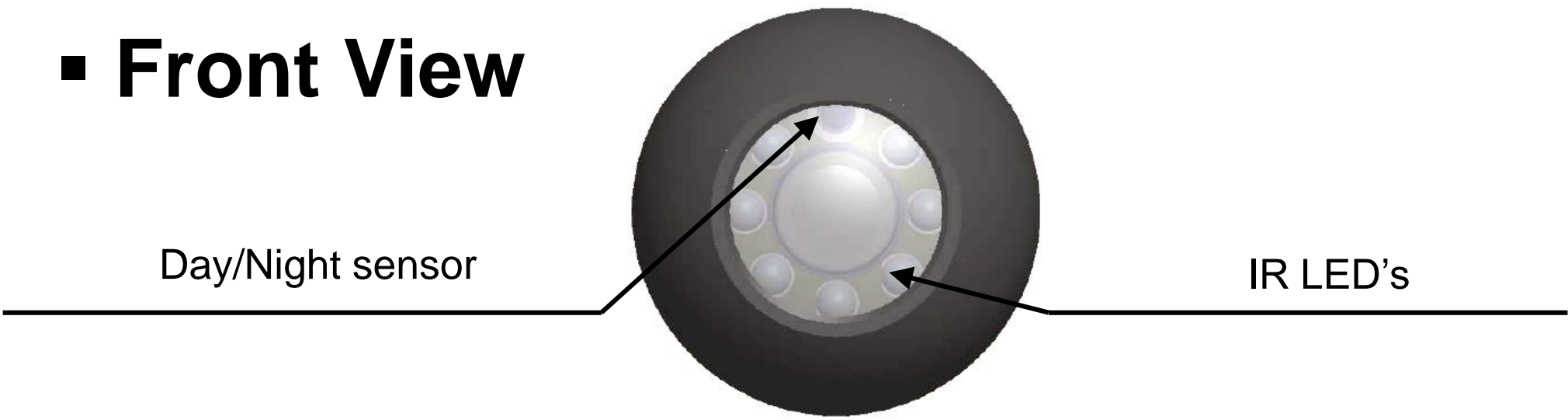

Rear View

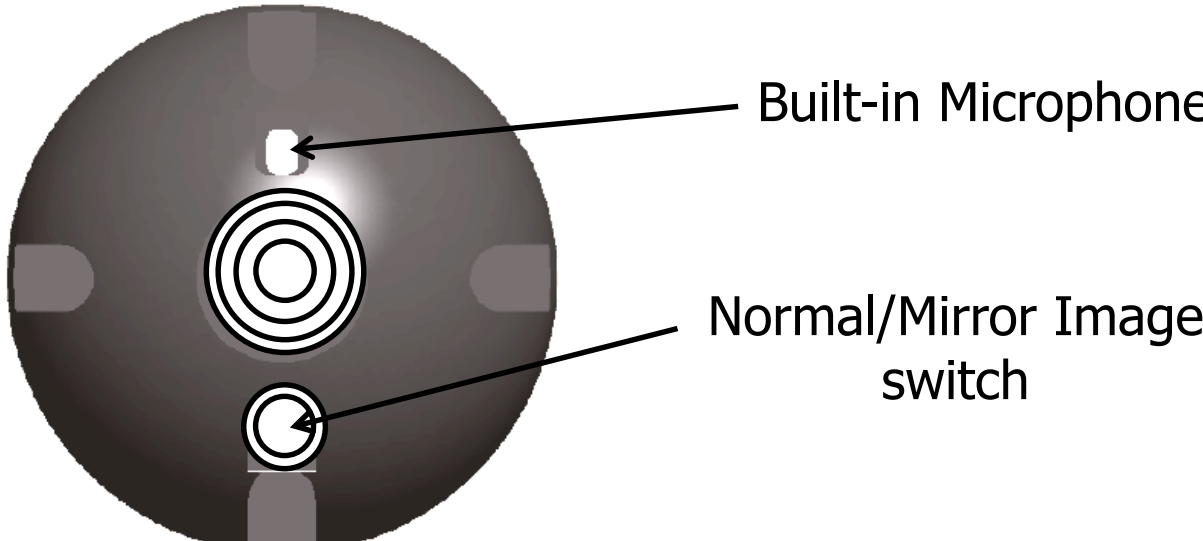

Installation

Camera Assembly

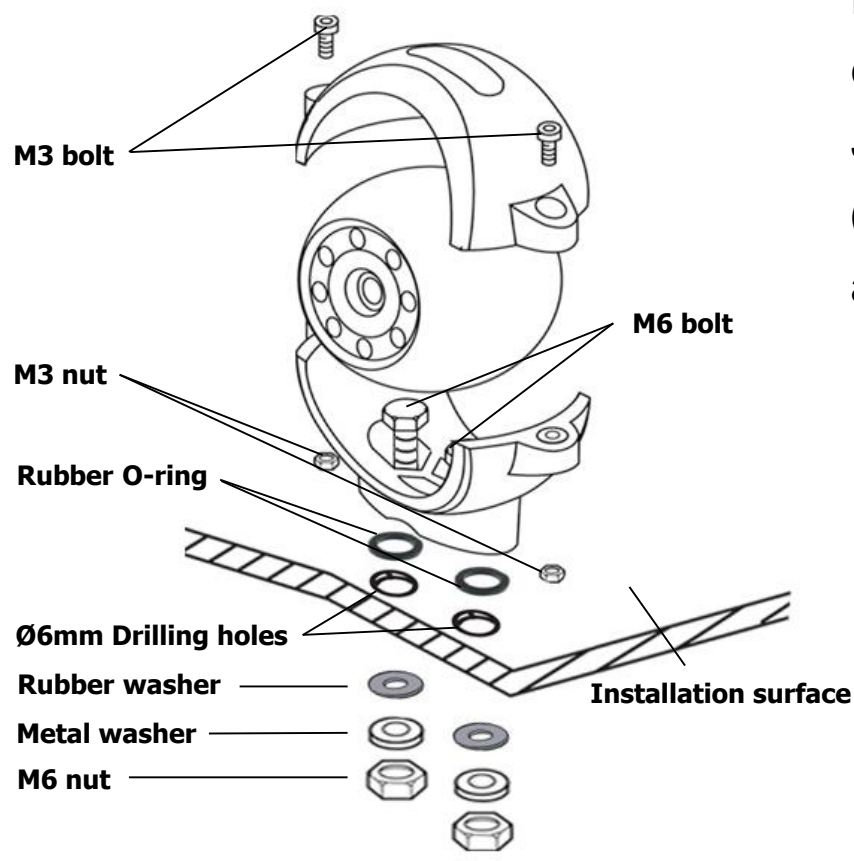

1. Fix the supplied camera bracket to the vehicle.
2. Fix the bracket with camera according to drawing.
3. Adjust the viewing angle of the camera and fasten the screws firmly.

Cable grommet

Drill a suitable hole (approx. Ø 19mm) and insert the cable grommet.
Just before final fixation, please apply a proper sealant (for prevention) between the hole and the grommet and also between the cable and the grommet.

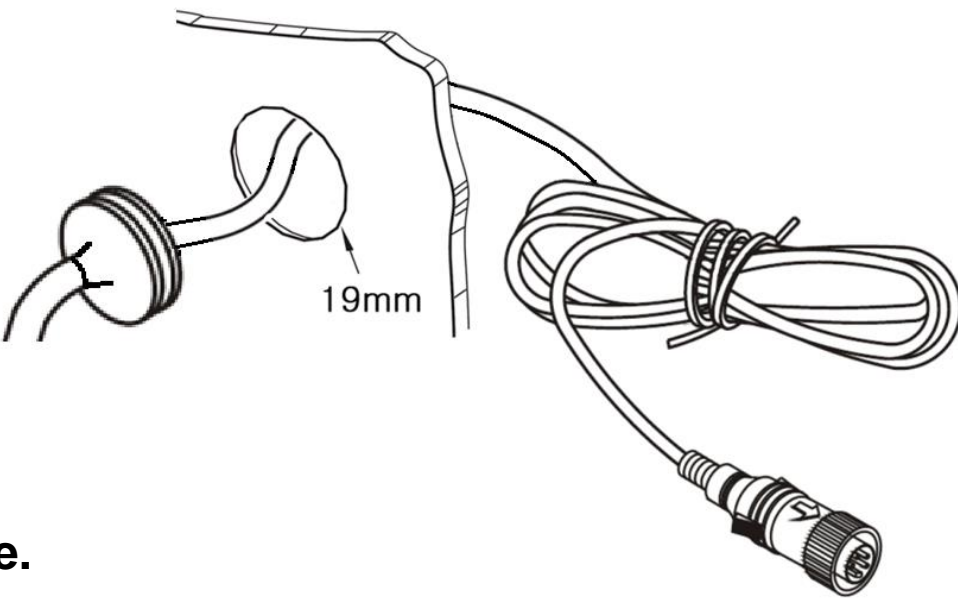

Securing cable connection

1. Match the arrow marks and press the connectors together.
2. Screw the camera connector up clockwise.



3. Tighten cable connection firmly in order to prevent water ingress.

Note!
The warranty will not be valid if the problem is related to moist / corrosion in the connector.

Wiring to Monitor

Run the cable from the camera to the monitor.

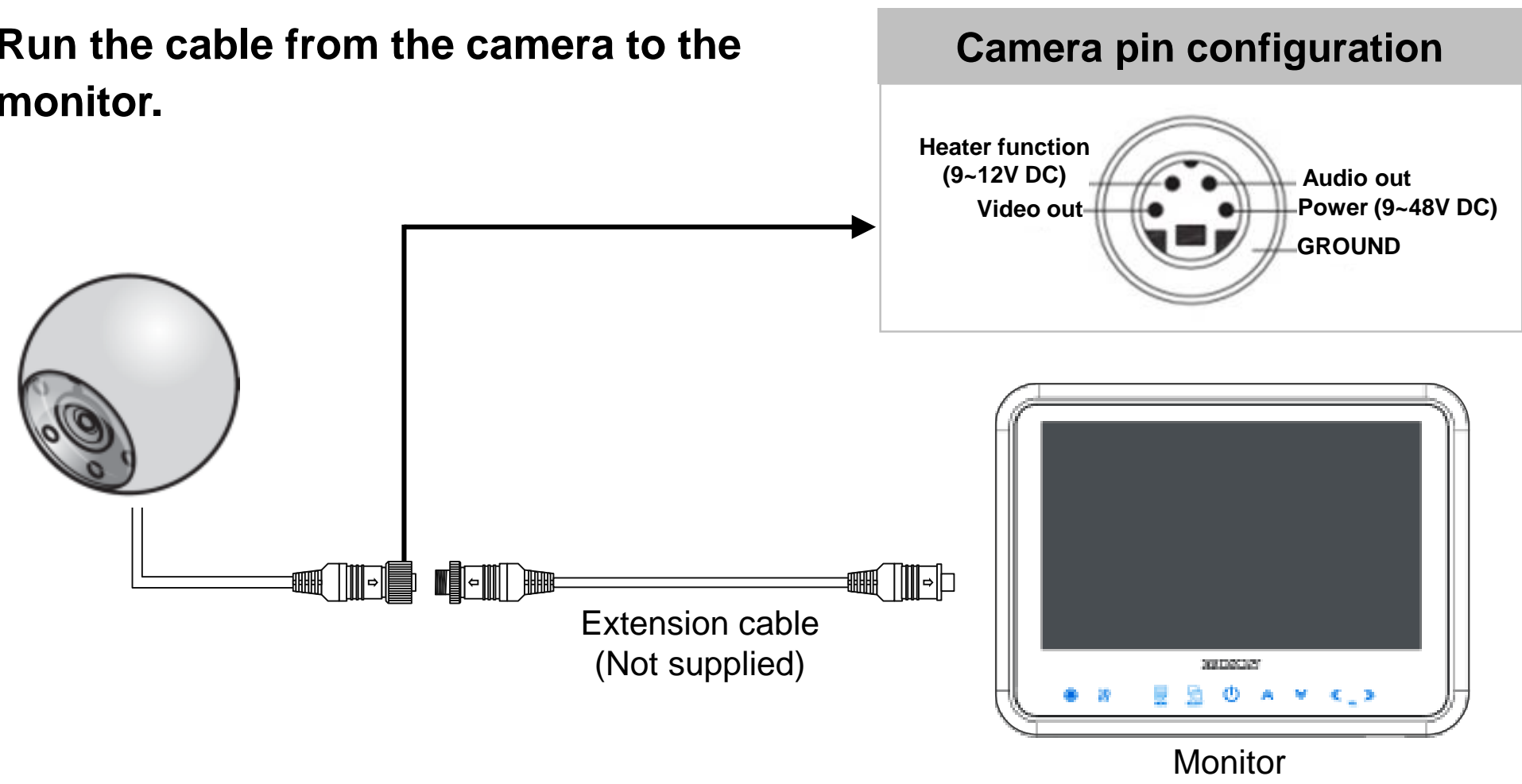

Caution !!

1. Before making the connection, disconnect the ground terminal from the battery to avoid short circuits.
2. The plugs should be fully inserted into the connectors or jacks. A loose connection may cause malfunctioning of the unit.
3. A damaged cable may affect the operation of the camera and may even cause a malfunction of the camera or monitor: Avoid a damaged cable!
4. Protect the cable by using a guide tube, pipe or run the cable inside the vehicle as much as possible. Caution! Run the cable in natural shapes in order to prevent cable breaks.
5. Preferably use an acid free grease in between the waterproof screw type connectors and tighten them firmly eachother.