

◆ MXN44C-TVI Camera



◆ Features

- Compact Mini Ball HD-TVI Color Camera
- 2.07 Mega pixels Full HD SONY CMOS Color camera
- 1/2.8" Color CMOS high resolution image sensor (STARVIS)
- HD-TVI 1080p 30fps
- IP69K Waterproof Rating
- Diagonal 154°, 140° or 66° Viewing angle
- Normal/Mirror Image adjustable (via loop wire)
- Ultra low light performance
- Automatic Electronic Iris
- Built-in Microphone (for one-way Audio)
- Multi purpose (Frontview, Sideview, Rearview, Surveillance, etc)
- Temperature Range -40°C to +80°C
- Vibration resistant (10G)
- Waterproof screw type connector, 4-pin mini-DIN
- ECE R10.05 approved (EMC)

Available versions of model MXN44C-TVI:

- | | |
|----------------|----------------------------|
| MXN44C-078-TVI | 66°(D) x 58°(H) x 32°(V) |
| MXN44C-140-TVI | 140°(D) x 124°(H) x 67°(V) |
| MXN44C-160-TVI | 154°(D) x 133°(H) x 93°(V) |

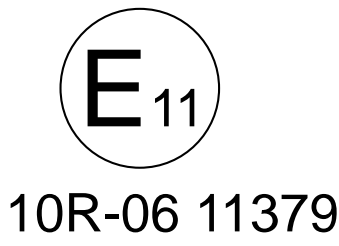

◆ Contents

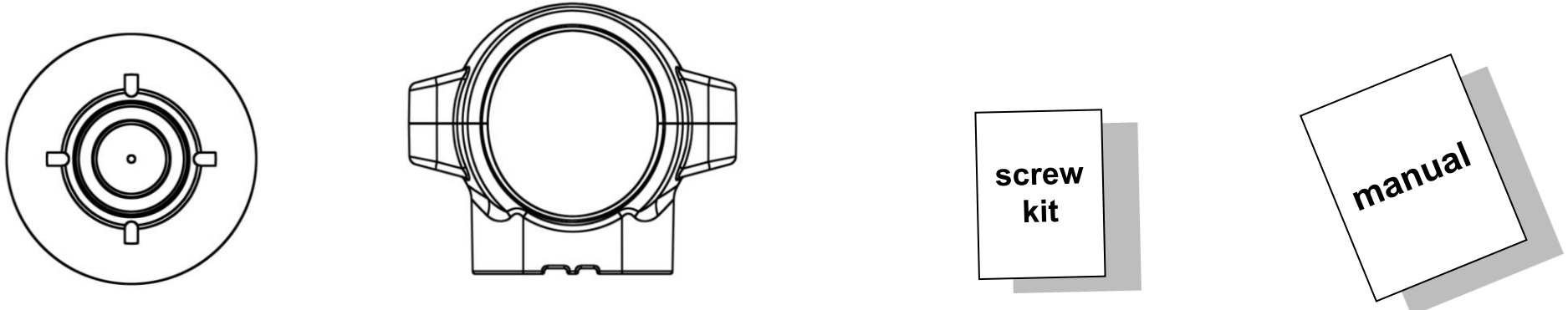

Camera x 1 Camera Bracket x 1 Screw kit x 1 Manual x 1

◆ Technical Specifications

Image Sensor	: 1/2.8" SONY CMOS Sensor (STARVIS)
Effective Pixels	: 2.07 Mega pixels 1920(H) X 1080(V)
Resolution	: 1080 TV lines
Scanning System	: Progressive
Video Output	: HD-TVI 4.0, 1080P/30fps
Audio Input	: High Sensitive C-Microphone
S/N ratio	: Minimum 48dB (at AGC off)
Minimum illumination	: 0.5 Lux (50IRE)
Power consumption	: DC 12V, 100mA
Power range	: DC 9 ~ 48V
Operating temperature	: -40°C to +80°C
Viewing angle	: 140°(Diagonal) x 124°(Horizontal) x 67°(Vertical)
Dimensions	: Ø38mm, 59(W) x 38(D) x 50(H) incl. bracket
Weight	: Approx. 107g (total weight incl. bracket : 120g)

◆ Installation

■ Camera Assembly

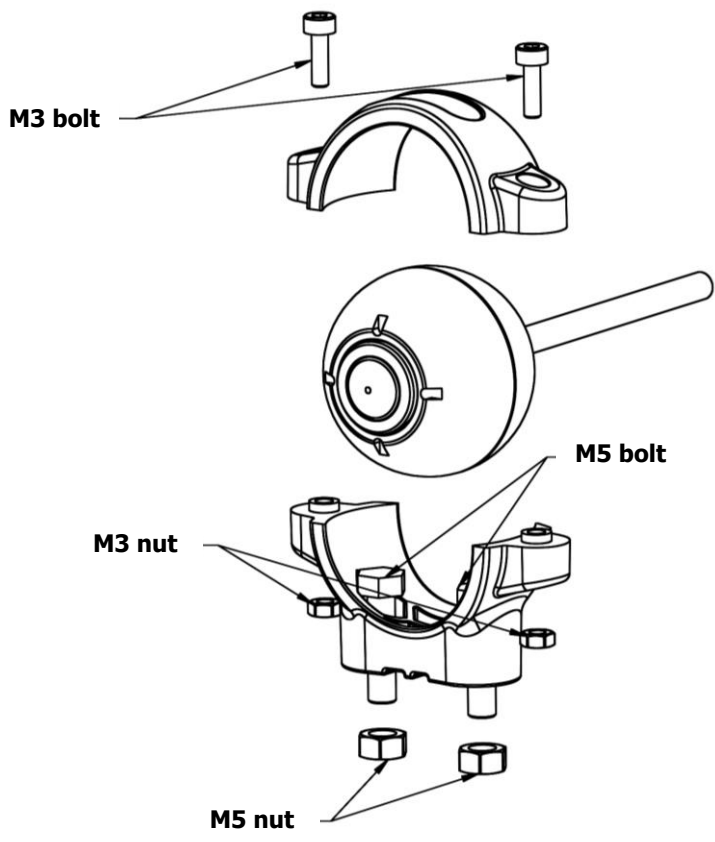

1. Fix the supplied camera bracket to the vehicle.
2. Fix the bracket with camera according to drawing.
3. Adjust the viewing angle of the camera and fasten the screws firmly.

■ Cable grommet

Drill a suitable hole (approx. Ø 19mm) and insert the cable grommet.
Just before final fixation, please apply a proper sealant (for prevention) between the hole and the grommet and also between the cable and the grommet.

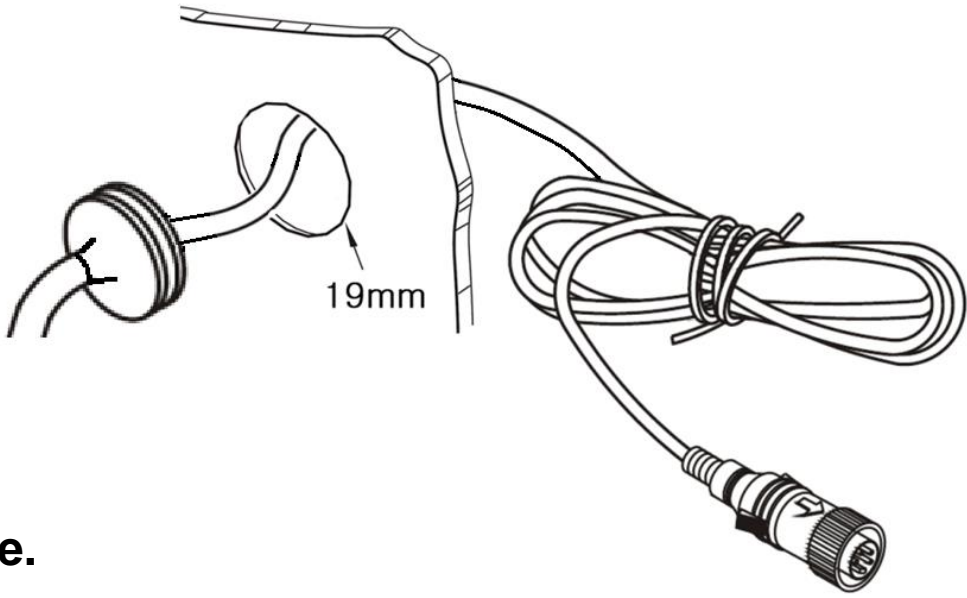

■ Wiring to Monitor

Run the cable from the camera to the monitor.

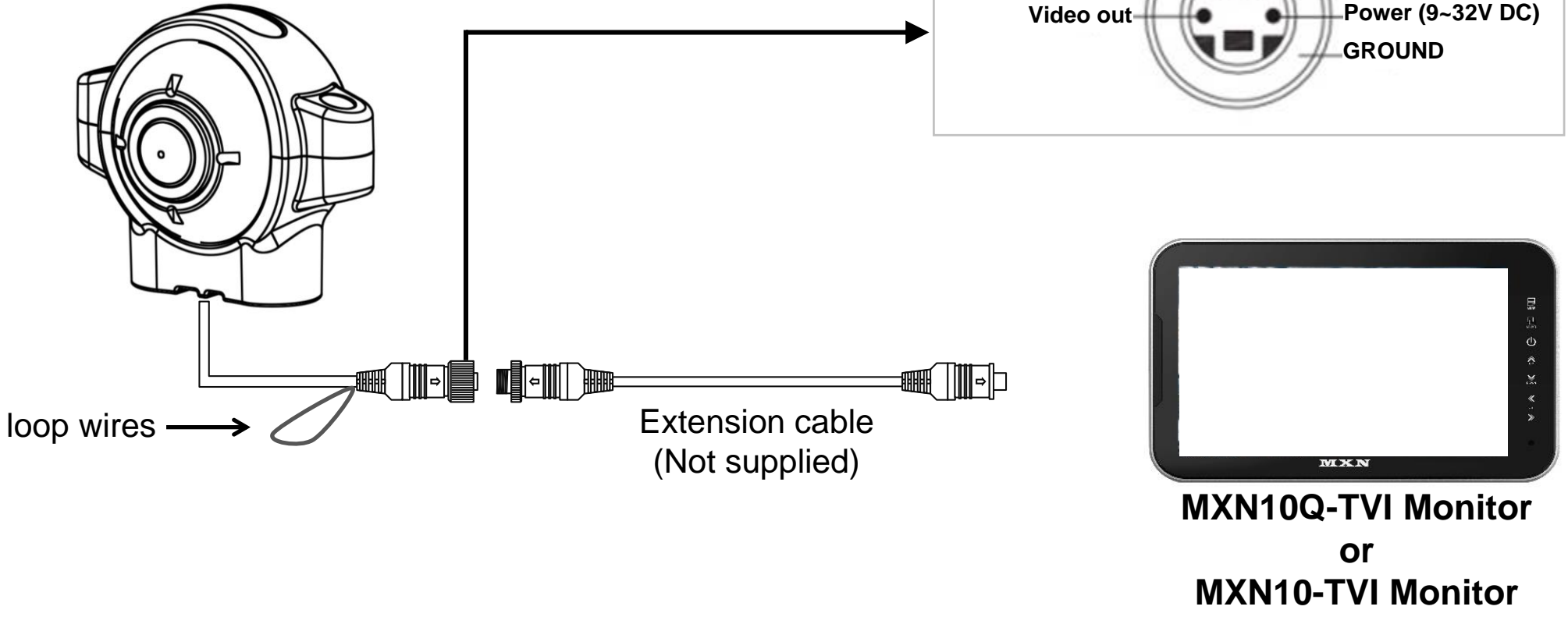

■ Normal / Mirror Image adjustment

The Normal / Mirror image can be changed via the GREEN loop wire:

- * Green loop wire un-cut : MIRROR image
- * Green loop wire cut : NORMAL image

■ Securing cable connection

1. Match the arrow marks and press the connectors together.
2. Screw the camera connector up clockwise.



3. Tighten cable connection firmly in order to prevent water ingress.

Note!
Warranty will not be valid if the problem is related to moist / corrosion in the connector.

■ Caution !!

1. Before making the connection, disconnect the ground terminal from the battery to avoid short circuits.
2. The plugs should be fully inserted into the connectors or jacks. A loose connection may cause malfunctioning of the unit.
3. A damaged cable may affect the operation of the camera and may even cause a malfunction of the camera or monitor: Avoid a damaged cable!
4. Protect the cable by using a guide tube, pipe or run the cable inside the vehicle as much as possible. Caution! Run the cable in natural shapes in order to prevent cable breaks.
5. Preferably use an acid free grease in between the waterproof screw type connectors and tighten them firmly eachother.